



Madison, Wisconsin

# CITY OF MADISON

## CITY ENGINEERING DIVISION

### DEPARTMENT OF PUBLIC WORKS

# PLAN OF PROPOSED IMPROVEMENT

## S. PATERSON STREET SANITARY SEWER REPLACEMENT ASSESSMENT DISTRICT - 2024

#### INDEX OF SHEETS

SHEET NO. U1-U2	SEWER PLAN & PROFILES
SHEET NO. U3	SANITARY SEWER SCHEDULE
SHEET NO. M1-M3	PAVEMENT MARKING PLAN

CITY PROJECT NO. 15332  
CONTRACT NO. 9561

PROJECT  
LOCATION

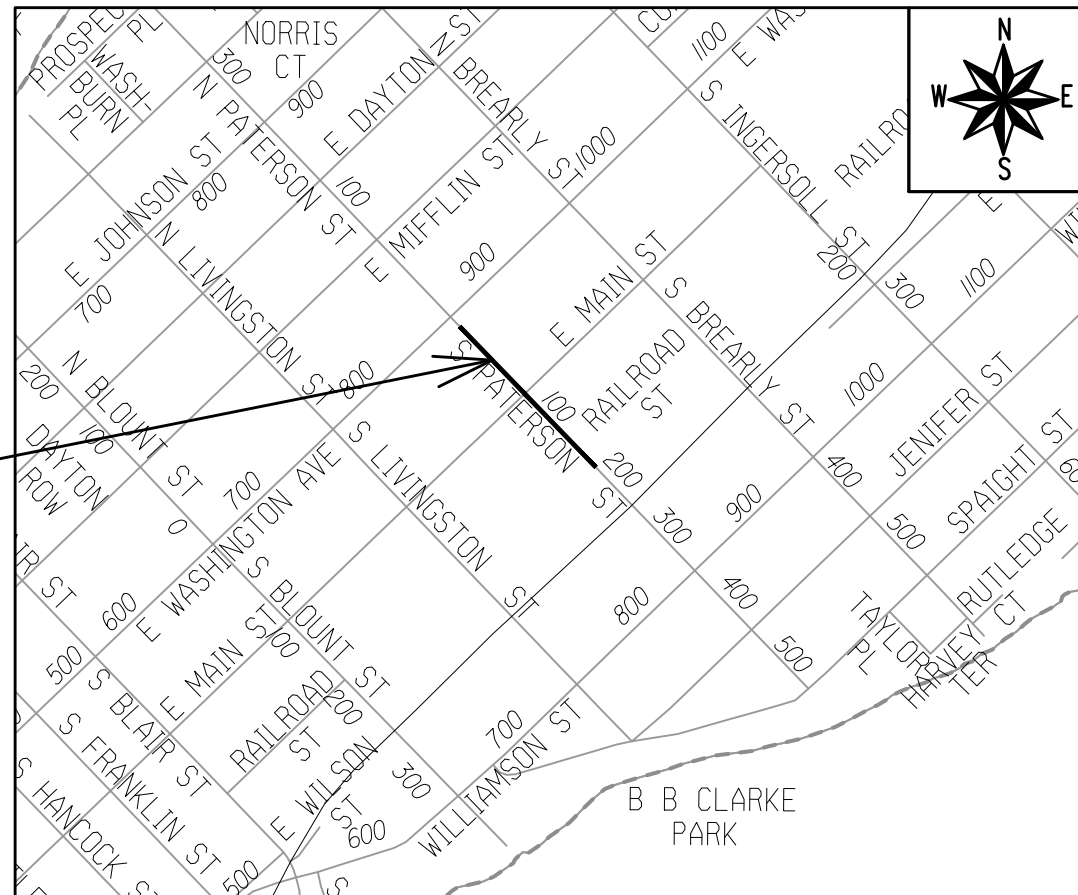

PUBLIC IMPROVEMENT PROJECT  
APPROVED

AUGUST 6, 2024.

BY THE COMMON COUNCIL  
OF MADISON, WISCONSIN

PUBLIC IMPROVEMENT DESIGN  
APPROVED BY:

Aug 16, 2024

City Engineer

Date

SANITARY SEWER  
DESIGNED BY:



Aug 16, 2024

PAVEMENT MARKING  
DESIGNED BY:

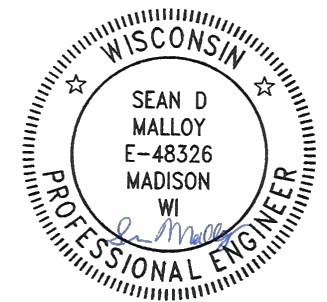

Aug 16, 2024

ADDENDUM #1 08/26/2024  
REVISED SHEETS: TITLE, U2, U3, M1-M3

PLOT SCALE: 1:1\_XREF

PLOT NAME: ---

REV. DATE: 8/14/2024 3:27 PM

ORIGINATOR: CITY\_OF\_MADISON

**EC NOTES:**

1. INLET PROTECTION, RIGID FRAME, SHALL BE INSTALLED IN ALL INLETS ADJACENT TO THE PROJECT LIMITS AND AT INTERSECTIONS WITHIN ONE (1) BLOCK OF THE PROJECT LIMITS
2. CONSTRUCTION ENTRANCES SHALL BE INSTALLED AT ALL LOCATIONS AS DIRECTED IN THE FIELD BY CITY ENGINEERING
3. STREET SWEEPING SHALL OCCUR AT THE END OF EACH WORK DAY

070913121087  
929 E Washington Ave  
ARCHIPELAGO VILLAGE LLC

**NOTE:** TYPE III TRENCH PATCH SHALL BE USED TO RESTORE PAVEMENT DAMAGED BY SANITARY SEWER INSTALLATION. IF WEATHER DOES NOT ALLOW ASPHALT, TEMP CONCRETE (7" OF CONCRETE ON 12" CRUSHED STONE BASE) SHALL BE USED AS AN ALTERNATIVE UNTIL WEATHER ALLOWS FOR TYPE III TRENCH PATCHING. TEMP CONCRETE PATCHING SHALL BE INCIDENTAL TO TYPE III TRENCH PATCH ITEM.

070913409037  
115 S Paterson St  
CITY OF MADISON WATER UT  
VEHICLE STORAGE BLDG

070913410175  
10 S Paterson St  
BAKERS PLACE SPE LLC

070913411016  
110 S Paterson St  
CITY OF MADISON WATER UT  
UTILITY OPERATIONS CENTER

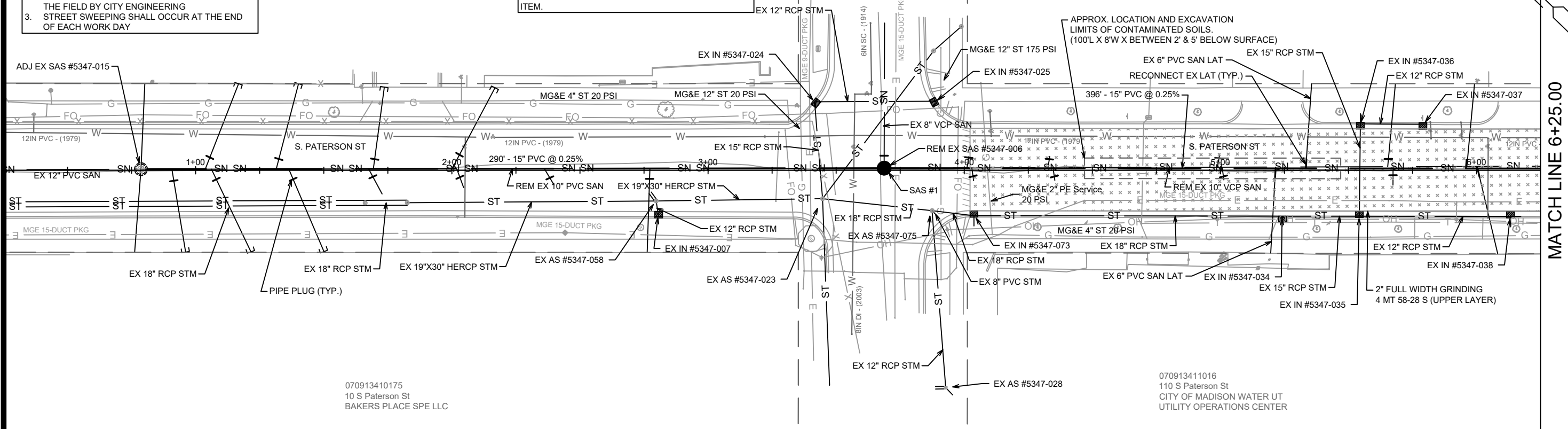

MATCH LINE 6+25.00

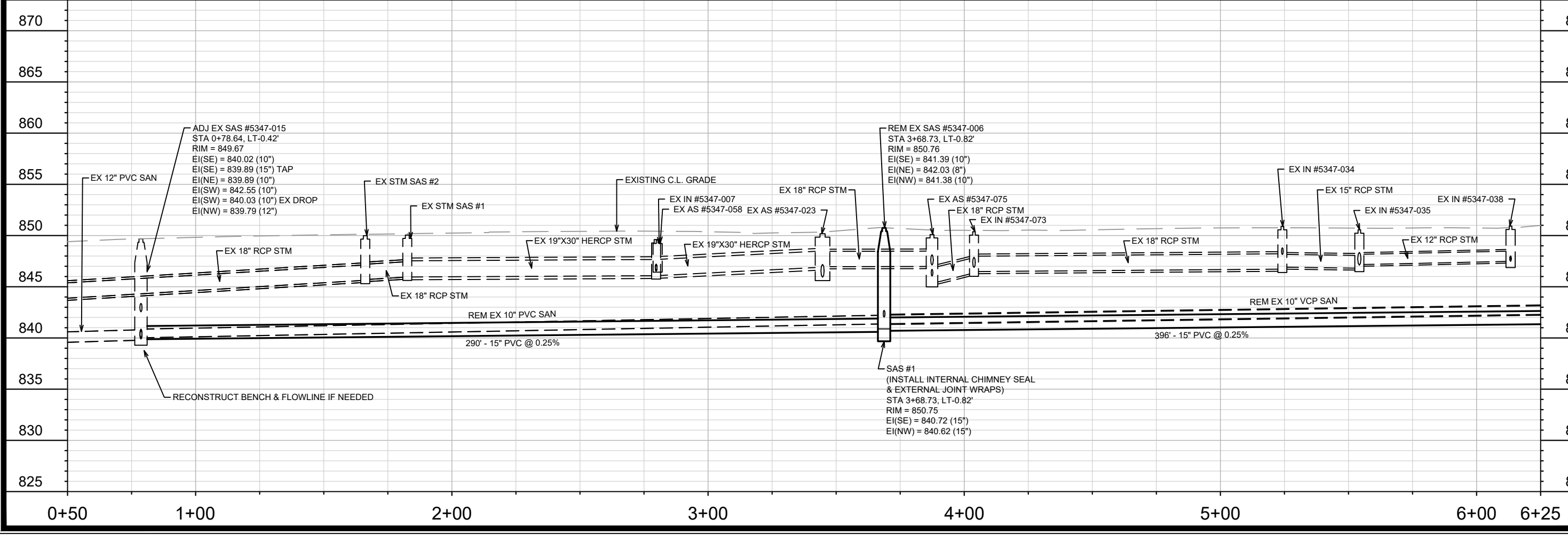

DATE	BY
REVISION	DATE
DESIGNED BY	SCALE
DATE	SCALE
15332	U-1

15332  
 MADISON, WI  
 S. PATERSON ST SANITARY SEWER REPLACEMENT ASSESS DIST - 2024  
 CONTRACT NO: 9561  
 U-1  
 15332

SEWER PLAN & PROFILE - S. PATERSON STREET  
 S. PATERSON ST SANITARY SEWER REPLACEMENT ASSESS DIST - 2024  
 U-1



MATCH LINE 6+25.00

NOTE: TYPE III TRENCH PATCH SHALL BE USED TO RESTORE PAVEMENT DAMAGED BY SANITARY SEWER INSTALLATION. IF WEATHER DOES NOT ALLOW ASPHALT, TEMP CONCRETE (7" OF CONCRETE ON 12" CRUSHED STONE BASE) SHALL BE USED AS AN ALTERNATIVE UNTIL WEATHER ALLOWS FOR TYPE III TRENCH PATCHING. TEMP CONCRETE PATCHING SHALL BE INCIDENTAL TO TYPE III TRENCH PATCH ITEM.

CASING PIPE TO BE SIZED BY THE CONTRACTOR. MIN. CASING SIZE 24" DIAMETER.

PVC CARRIER PIPE

PRE-FABRICATED SPACER OR BLOCKS

FILL VOIDS W/ BLOWN SAND.

NOTE:  
WALL THICKNESS FOR STEEL CASING PIPE WITH 35,000 P.S.I. MIN. YIELD STRENGTH. FOR MATERIAL OF LOWER YIELD STRENGTH, INCREASE THICKNESS AN ADDITIONAL 1/16".

STEEL CASING PIPE FOR E80 LOADING	
MIN. THK. (IN.) FOR PIPE NOT CATHODICALLY PROTECTED	CASING PIPE DIAMETER (IN.)
0.3750	18 - 22
0.4375	22 - 25
0.5000	25 - 34
0.5625	34 - 42
0.6250	42 - 48

**RAILROAD CASING PIPE DETAIL**  
NOT TO SCALE

- EC NOTES:**
1. INLET PROTECTION, RIGID FRAME, SHALL BE INSTALLED IN ALL INLETS ADJACENT TO THE PROJECT LIMITS AND AT INTERSECTIONS WITHIN ONE (1) BLOCK OF THE PROJECT LIMITS
  2. CONSTRUCTION ENTRANCES SHALL BE INSTALLED AT ALL LOCATIONS AS DIRECTED IN THE FIELD BY CITY ENGINEERING
  3. STREET SWEEPING SHALL OCCUR AT THE END OF EACH WORK DAY

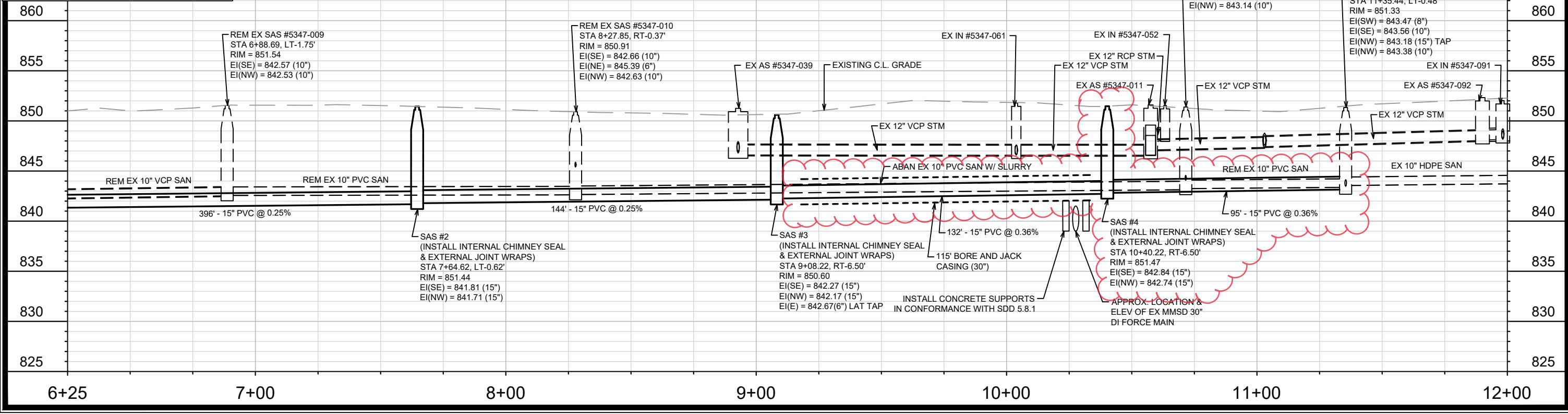

15332

MADISON, WI

CONTRACT NO.: 9561

U-2

15332

U-2

Scale: 1" = 40'

DESIGNED BY: KDF

DATE: 8/26/2024 2:08 PM

REVISION: 8/26/24

BY: KDF

15332

15332

U-2



# SANITARY SEWER SCHEDULE

\*ADDEN 8/26/24 KDF

S. PATERSON ST SANITARY SEWER	SHEET NO.
ASSESS DIST - 2024	U-3
SANITARY SEWER SCHEDULE	
CITY OF MADISON	

## PROPOSED SANITARY STRUCTURES

SAS NO.	STATION	LOCATION (OFFSET)	TOP OF CASTING	E.I.	DEPTH	NOTES
<b>PATERSON STREET</b>						
SAS #1	3+68.73	LT-0.82	850.75	840.72	10.03	[1], [2]
SAS #2	7+64.62	LT-0.62	851.44	841.71	9.73	[1], [2]
* SAS #3	9+08.22	RT-6.50	850.60	842.17	8.43	[1], [2]
* SAS #4	<b>10+40.22</b>	<b>RT-6.50</b>	<b>851.47</b>	842.74	<b>8.73</b>	[1], [2]

## PROPOSED SANITARY PIPES

FROM (DNSTM)	TO (UPSTM)	DWNSTRM E.I.	UPSTRM E.I.	PLAN (PAY) LGTH (FT)	SLOPE (%)	PIPE SIZE	PVC TYPE	NOTES
<b>PATERSON STREET</b>								
EX SAS #5347-015	SAS#1	839.89	840.62	290	0.25%	15"	SDR-35	-
SAS #1	SAS #2	840.72	841.71	396	0.25%	15"	SDR-35	-
SAS #2	SAS #3	841.81	842.17	144	0.25%	15"	SDR-35	-
* SAS #3	SAS #4	842.27	842.74	<b>132</b>	<b>0.36%</b>	15"	SDR-35	-
* SAS #4	EX SAS#1	842.84	843.18	<b>95</b>	<b>0.36%</b>	15"	SDR-35	-

## REMOVE SANITARY STRUCTURES

SAS NO.	STATION	LOCATION (OFFSET)	TOP OF CASTING	E.I.	DEPTH	NOTES
<b>PATERSON STREET</b>						
EX SAS #5347-006	3+68.73	LT-0.82	850.76	841.38	9.38	-
EX SAS #5347-009	6+88.69	LT-1.75	851.54	842.53	9.01	-
EX SAS #5347-010	8+27.85	RT-0.37	850.91	842.63	8.28	-
EX SAS #5347-011	10+71.55	LT-1.18	851.38	843.14	8.24	-

## REMOVE AND ABANDON SANITARY PIPES

FROM DOWNSTREAM	TO UPSTREAM	REM LENGTH	PAID (Y/N)	PAID REM LENGTH	ABN LENGTH	PIPE SIZE	PIPE TYPE	NOTES
<b>PATERSON STREET</b>								
EX SAS #5347-015	EX SAS #5347-006	290	N	-	-	10"	PVC	-
EX SAS #5347-006	EX SAS #5347-009	320	N	-	-	10"	VCP	-
EX SAS #5347-009	EX SAS #5347-010	139	N	-	-	10"	PVC	-
EX SAS #5347-010	EX SAS #5347-011	-	Y	-	244	10"	PVC	ABAN W/ SLURRY
EX SAS #5347-011	EX SAS #1	64	Y	17	-	10"	PVC	-

## ADJUST EXISTING SANITARY STRUCTURES

SAS NO.	STATION	LOCATION (OFFSET)	TOC	PROP TOC	ADJ (FT)	NOTES
<b>PATERSON STREET</b>						
EX SAS #5347-015	0+78.64	LT-0.42	849.67	849.67	0.00	-

## SANITARY SEWER ULOS

ULO NO.	STATION	LOCATION (OFFSET)	TYPE	TOP ELEV.	NOTES
<b>PATERSON STREET</b>					
ULO1	9+46.52	RT-6.50	ELECTRIC	-	-
ULO2	9+49.19	RT-6.50	GAS	-	-
ULO3	9+51.86	RT-6.50	FIBER OPTIC	-	-
ULO4	9+85.46	RT-6.50	FIBER OPTIC	-	-
ULO5	9+90.44	RT-6.50	FIBER OPTIC	-	-
ULO6	9+94.60	RT-6.50	FIBER OPTIC	-	-
ULO7	10+27.62	RT-6.50	MMSD FORCE MAIN	-	-
ULO8	10+54.82	RT-5.43	FIBER OPTIC	-	-

## SPECIFIC NOTES

- [1] INSTALL EXTERNAL SAS WRAP IN CONFORMANCE WITH SDD 5.7.2
- [2] INSTALL RIGID INTERNAL CHIMNEY SEAL IN CONFORMANCE WITH SDD 5.7.17

E WASHINGTON AVE

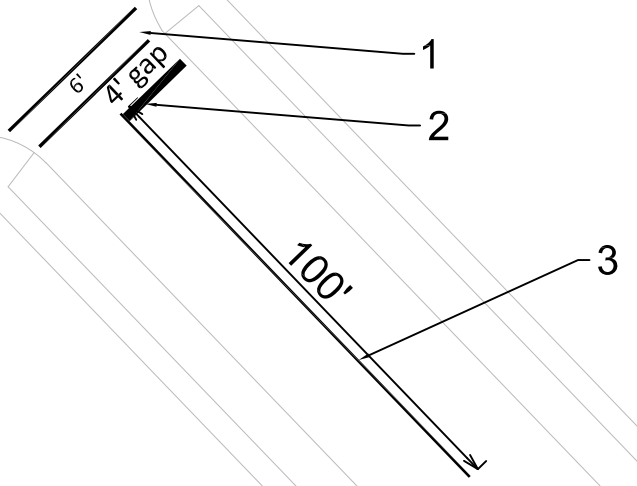

PAVEMENT MARKINGS	
1	PAVEMENT MARKING EPOXY, CROSSWALK, 6-INCH
2	PAVEMENT MARKING EPOXY, STOP LINE, 24-INCH
3	PAVEMENT MARKING EPOXY, DOUBLE LINE, 4-INCH
4	PAVEMENT MARKING EPOXY, CROSSWALK, 12-INCH
5	SKID/SLIP RESISTANT PREFORMED THERMOPLASTIC PAVEMENT MARKING, BIKE LANE GREEN
6	PAVEMENT MARKING EPOXY, SYMBOL, RAILROAD

Notes: All dimensions are to center of marking and face of curb, for layout questions, contact Ali Heinritz, aheinritz@cityofmadison.com 608.267.1102

S. PATERSON ST.

E MAIN ST

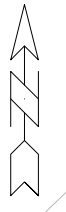
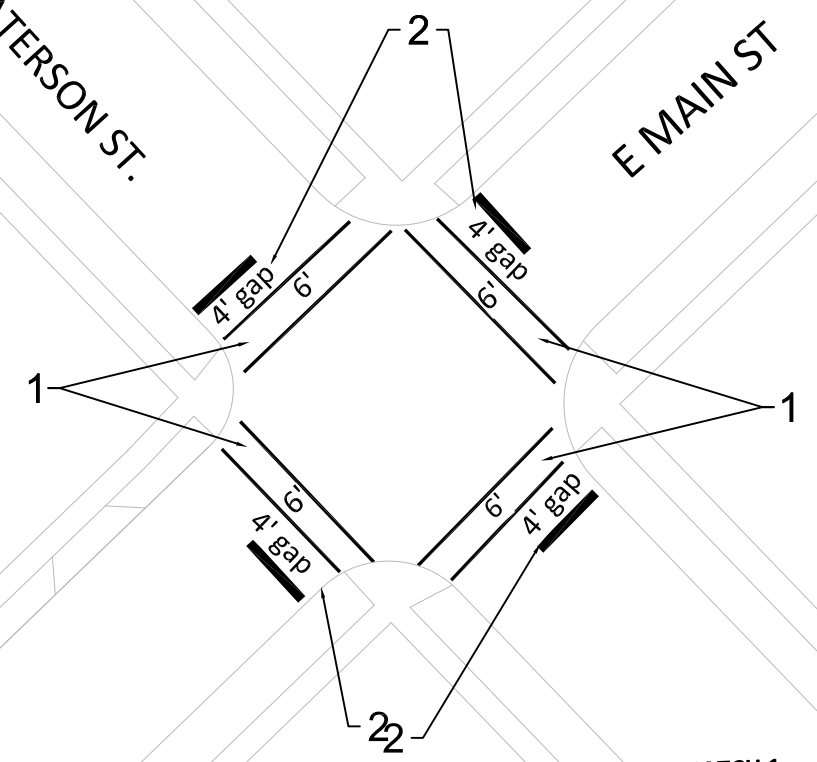

PAVEMENT MARKING PLAN

S. PATERSON ST SEWER PROJECT

C:\Users\Tnah\Documents\15332\TE-S.Paterson PSE.pvm.plan.dwg

MADISON, WI

15332

CONTRACT NO:



15332

M-1

MARK	REVISION	DATE	BY
###	###	###	###
###	###	###	###
###	###	###	###
###	###	###	###
###	###	###	###

Designed By: ##  
 Date: 8/16/2024 11:30 AM  
 Scale: Custom  
 Scale: ##

MATCH 1

DETAIL:

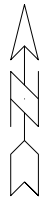
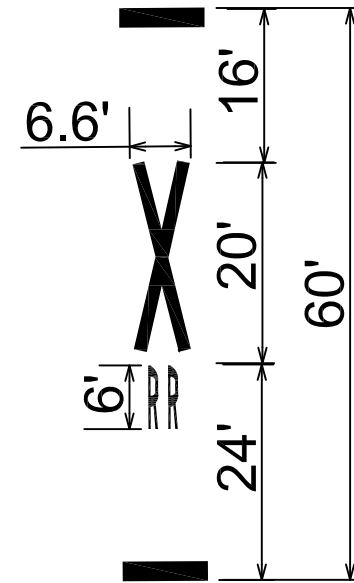

S. PATERSON ST.

PAVEMENT MARKINGS	
1	PAVEMENT MARKING EPOXY, CROSSWALK, 6-INCH
2	PAVEMENT MARKING EPOXY, STOP LINE, 24-INCH
3	PAVEMENT MARKING EPOXY, DOUBLE LINE, 4-INCH
4	PAVEMENT MARKING EPOXY, CROSSWALK, 12-INCH
5	SKID/SLIP RESISTANT PREFORMED THERMOPLASTIC PAVEMENT MARKING, BIKE LANE GREEN
6	PAVEMENT MARKING EPOXY, SYMBOL, RAILROAD

Notes: All dimensions are to center of marking and face of curb, for layout questions, contact Ali Heinritz, aheinritz@cityofmadison.com 608.267.1102

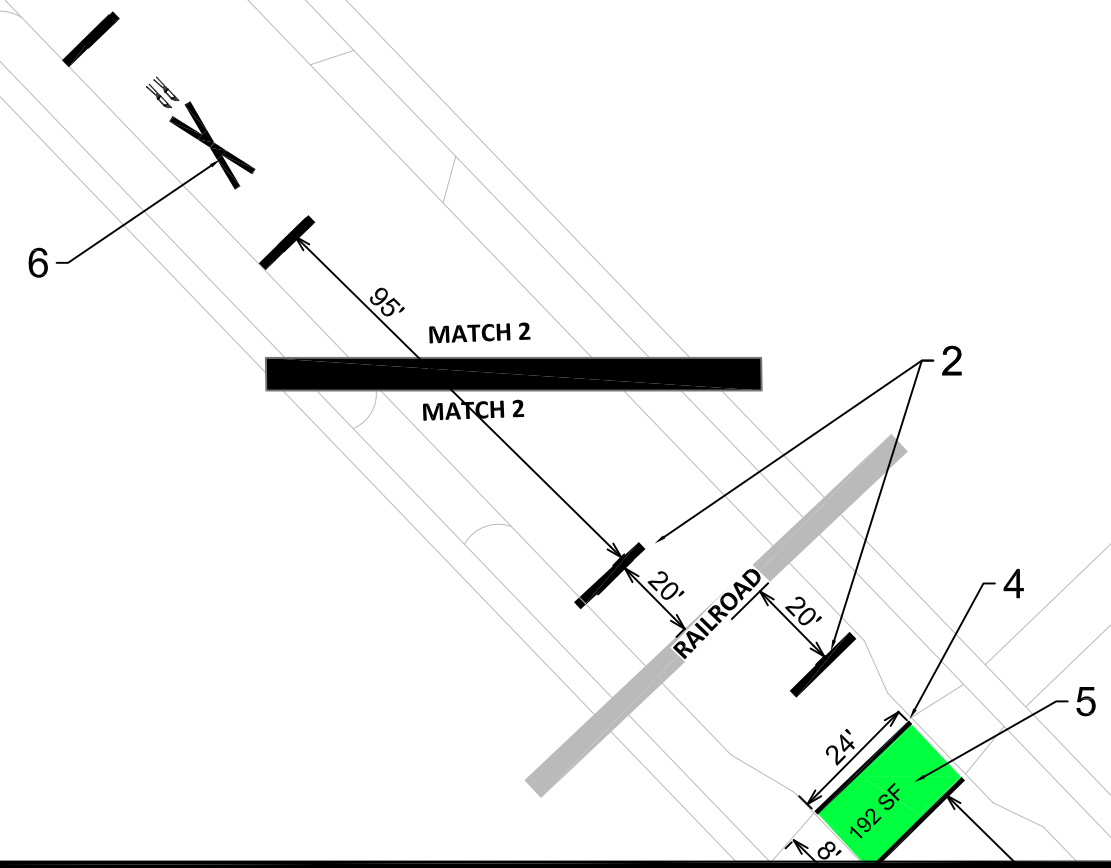

MARK	REVISION	DATE	BY
###	###	###	###
###	###	###	###
###	###	###	###
###	###	###	###

PAVEMENT MARKING PLAN  
 S. PATERSON ST SEWER PROJECT  
 MADISON, WI  
 CONTRACT NO: 15332

Designed By: A.H. Date: 8/16/2024 11:31 AM  
 Scale: Custom  
 C:\Users\Tnah\Documents\15332TE-S.Paterson PSE.pvm.plan.dwg



15332  
 M-2

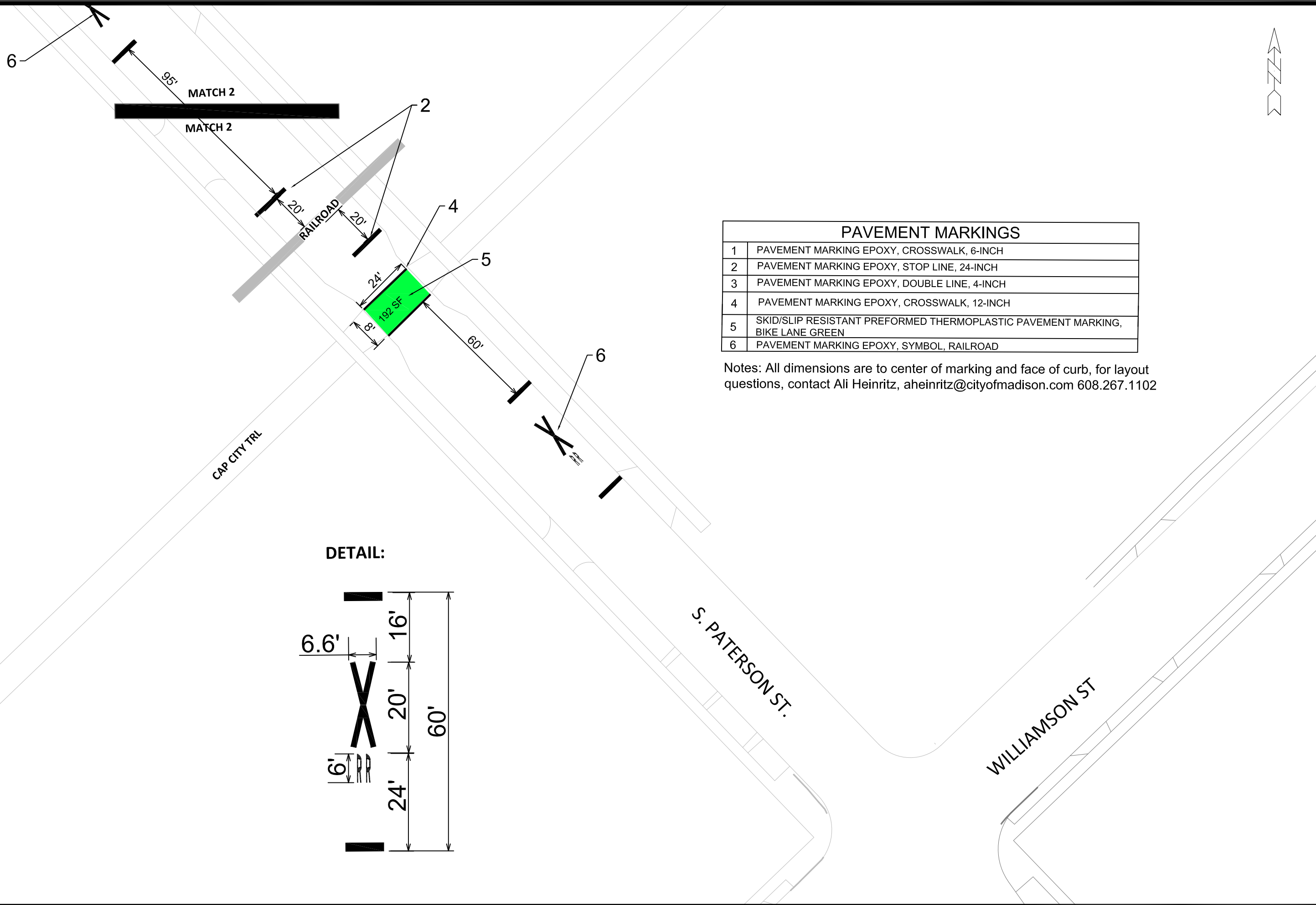

PAVEMENT MARKINGS	
1	PAVEMENT MARKING EPOXY, CROSSWALK, 6-INCH
2	PAVEMENT MARKING EPOXY, STOP LINE, 24-INCH
3	PAVEMENT MARKING EPOXY, DOUBLE LINE, 4-INCH
4	PAVEMENT MARKING EPOXY, CROSSWALK, 12-INCH
5	SKID/SLIP RESISTANT PREFORMED THERMOPLASTIC PAVEMENT MARKING, BIKE LANE GREEN
6	PAVEMENT MARKING EPOXY, SYMBOL, RAILROAD

Notes: All dimensions are to center of marking and face of curb, for layout questions, contact Ali Heinritz, aheinritz@cityofmadison.com 608.267.1102

**DETAIL:**

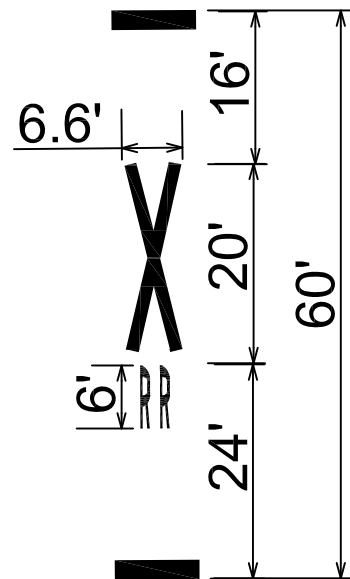

MARK	REVISION	DATE	BY
###	###	###	###
###	###	###	###
###	###	###	###
###	###	###	###

PAVEMENT MARKING PLAN  
 S. PATERSON ST SEWER PROJECT  
 C:\Users\Tnah\Documents\15332TE-S.Paterson PSE pvm plan.dwg

MADISON, WI  
 CONTRACT NO: 15332



15332  
 M-3